

# Columbarium Program

# Design – Double-Sided Columbarium

## 32 Niche



# Columbarium Characteristics

- Unit Size 64”L X 39”W X 61”H
- Niches - 32 each - 12”W X 12”H X 16”D
- Each niche can hold 2 urns
- Material - Black granite doors  
light color Granite frame
- Nameplate will be engraved by  
Gaulden Monuments
- Free standing unit set on  
a concrete slab

# Benches

4 ft. Brooklyn Park Bench

Recycled Plastic



# Memorial Registry

- Two sided.
- Composite Material.
- Rubber tackboard.
- Acrylic Glass Doors with a seal.
- Stainless Steel Hinges.
- Viewing Area 42"W X 28.25"H
- Warranty – 50 years.



# Columbarium Location

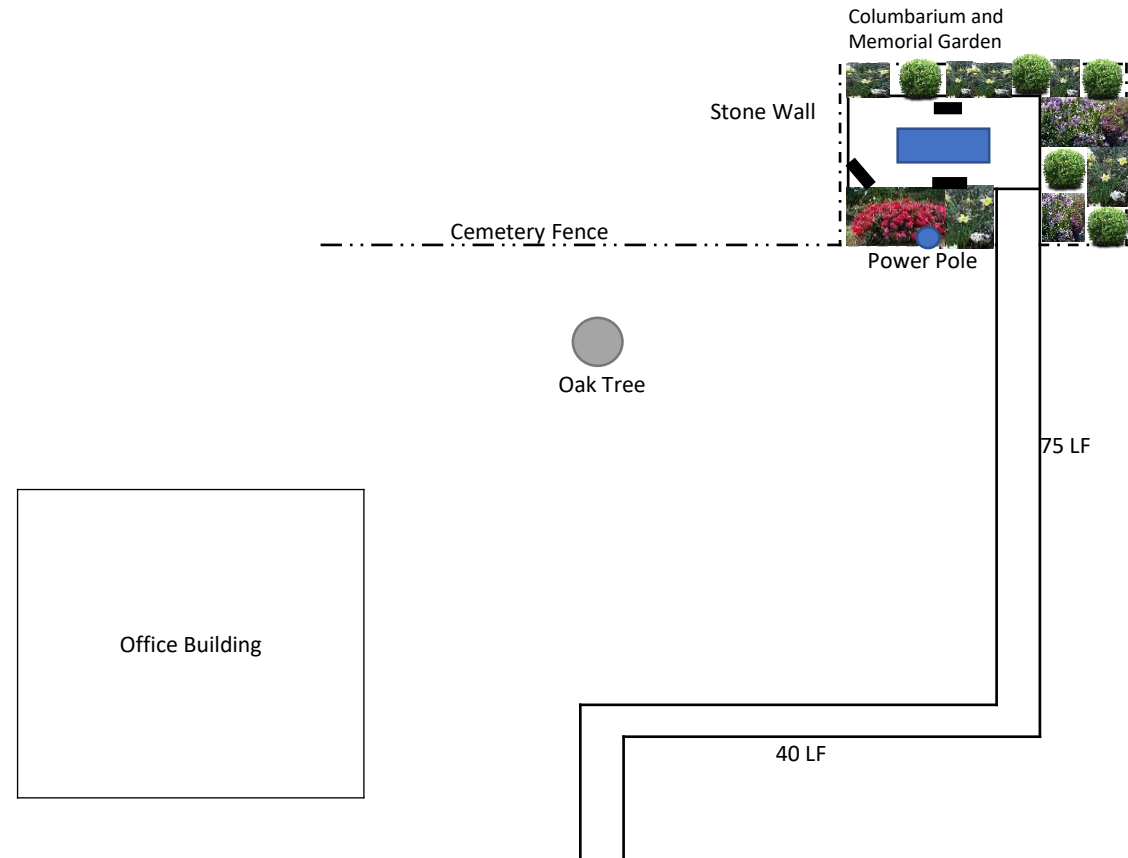

# Columbarium Layout

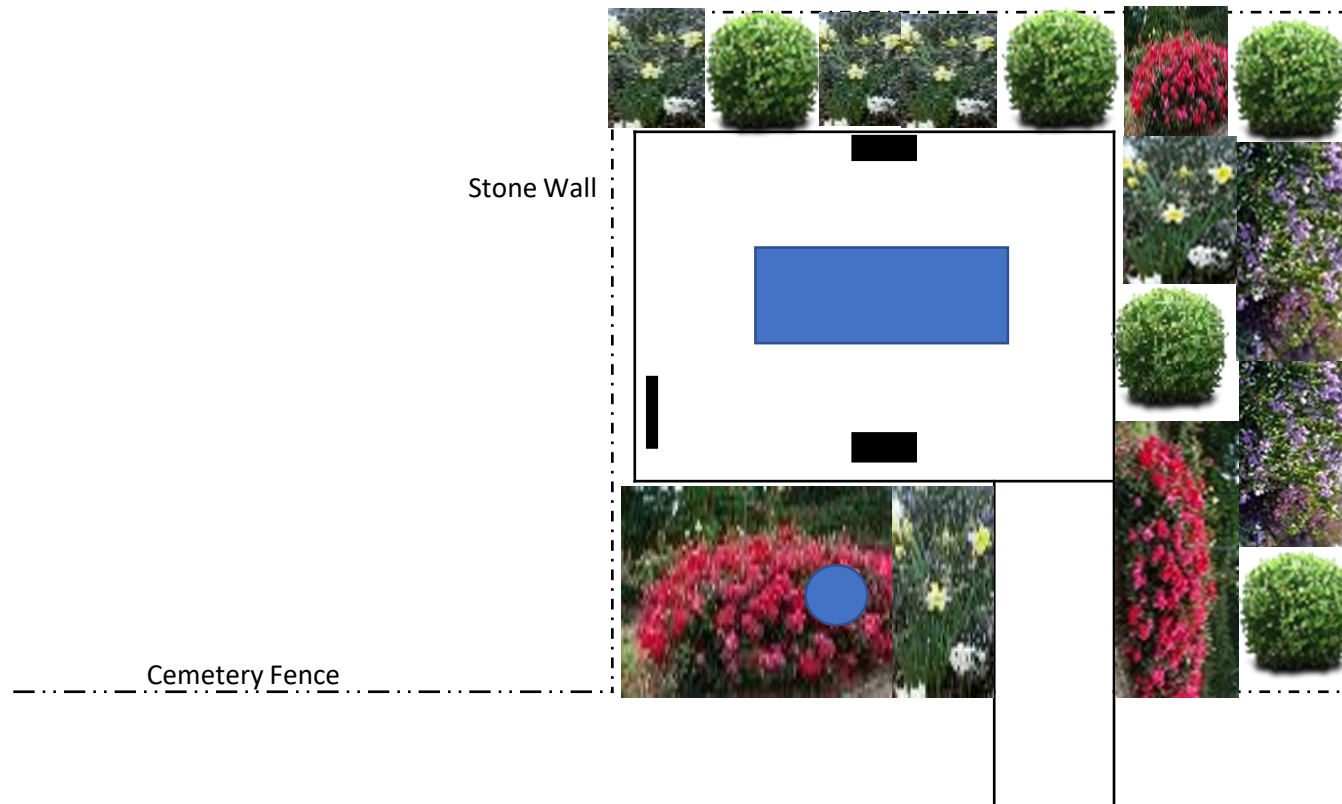

Not to Scale

# Total Estimated Cost

Columbarium Project Total \$25,000.00

- Includes:
  - Concrete Foundation
  - Columbarium
  - Initial Landscape

Sidewalk Option in concrete \$ 6,300.00

Total with Sidewalk Option \$31,045.00



# Estimated Niche Cost (selling 100% of the niches)

## Cost includes all of the following:

- Niche
- Engraving cost
- Opening & Closing of the niche
- Record-keeping
- Future Maintenance
- **COST PER NICHE** **\$1,625**

NOTE: Cost of an Urn is Not included.

# Niche Purchase Cost

## **Current Active Faith PC Members**

- Niche Cost for 6 months/min. 15 niches \$2,000.00
- Niche Cost for remaining niches \$2,200.00

## **Non-Members**

- Non-members \$3,000.00

# Comparison with Burial Grave Sites

## Burial Plot

Active Members - No Charge for Plot

Costs will be incurred for digging the grave, vault and closing it up. Approximate costs are \$2,700

Non-Members - \$2,100

Additional costs include digging the grave, vault, and closing it up. Approximate Costs are - \$2,700

Total for Non-Members - \$4,800

## Columbarium Niche

Active Members

Niche Cost \$2,200

Non-Members -

\$3,000

Niche Cost

# General Information

The Columbarium is a perpetual care program.

That is the Columbarium is owned by Faith Presbyterian Church and will be maintained by Faith Presbyterian Church for perpetuity.

Perpetual care requires a restricted account that can never be used for anything else but the Columbaria to ensure it is properly maintained.

The applicant is reserving the niche for perpetuity.

# Frequently Asked Questions

- What happens if a member moves their membership from Faith?
- Option 1
- Request the Cemetery Committee try to sell their membership to another Faith PC member at the price they paid.
- Option 2
- Pay the difference between the price they paid and the non-member price and keep the niche.
- Option 3
- The church may, upon request and at its discretion, repurchase the niche for \$350.00.

# Frequently Asked Questions

## **How will the columbarium be financed?**

Funding for the columbarium is provided through the sale of niches, donor contributions and memorial gifts. Construction will not begin until enough niches have been sold or contributions received to cover the cost of construction. The columbarium will be self-supporting including maintenance and perpetual care.

## **How much does a niche cost and what is included in the price?**

For the first 6 months or 15 niches, the cost will be \$2,000.00. After that, the cost will be \$2,200.00 per niche.

# Frequently Asked Questions

## **When will payment be due?**

Payments will be due once the first 15 niches have been reserved.

After the first 15 niches have been sold, payment will be due with the application.

# Frequently Asked Questions

## **What does the price include?**

The price includes the <sup>1</sup>niche, inurned for a maximum of two. This assumes that the urns are of the appropriate size, <sup>2</sup>engraving the face plate with the name and life dates of the person(s) whose cremains are inurned, <sup>3</sup>choice of available niche location, <sup>4</sup>opening and closing of the inurnment space, <sup>5</sup>record-keeping, and <sup>6</sup>maintenance in perpetuity. It does not include the cost of an urn, cremation or anything else associated with the inurnment.

## **Are there any financing options?**

No. Payments for the niches and plaques must be paid in full at the time of purchase. Funds for the first 15 niches will not be accepted until at least 15 niches are sold. Payment will be due at that time.



# Frequently Asked Questions

## **Who can be inurned in the columbarium?**

Members or former members, pastors and staff of the Church, their current or prior spouses or partners, their children (natural or adopted) and step-children, their parents, and ordained Presbyterian pastors and their current or prior spouses or partners may be inurned at the columbarium and, when completed, memorialized on a plaque to be placed in the area. Anyone else must have Session approval.

## **What is inscribed on the niche?**

The person's or persons' full name(s) with month, date and years of birth and death. For an additional cost, the branch(s) of the military that the person(s) served in may be added. This cost will be the prevailing cost at the time the request is made.

# Frequently Asked Questions

## **What is the size of the niche?**

Each niche is about 12 inches wide by 12 inches high by 16 inches deep.

## **What is an urn and how big is it?**

Urns are the receptacles into which ashes are placed. The urns are then placed in the niche. Recommended urn size is 9 ½ inches high, 7½ inches wide and 7 inches long.

The device that the ashes come in from the funeral home is acceptable as an urn as long as they are in a device and not only in a plastic bag. Nothing else is required.

# Frequently Asked Questions

## **May other items be inurned with the cremains?**

No. No valuables, trinkets or medals of any kind shall be placed in the urn or niche. The niche may be used only for the inurnment of ashes in an urn.

## **May I inurn my pet?**

A pet's ashes may be mixed with human cremains. The church does not allow, however, a separate inscription for the pet nor a separate urn.

# Frequently Asked Questions

## **What about cremains I already have?**

You may have them inurned in the columbarium after completion of the Niche Purchase Agreement and arrangement of a memorial service. Contact the pastor of Faith Church to arrange for a service and to obtain the information to purchase a niche.

## **May ashes of two people be co-mingled in a single urn?**

Yes. Either one or two urns may be used as long as they are sized to fit into the niche.

# Frequently Asked Questions

## **How do I purchase a niche?**

Submit a written application (Niche Purchase Agreement) and payment to the church. The agreement is available on the Church website under "Members/Forms". If you need a printed copy you can obtain one in the Church Office.

## **Do I actually own the niche?**

No, the niche purchase agreement is only a reservation to use the niche. No real property right or interest is created.

# Frequently Asked Questions

## **May I remove ashes from the columbarium for any reason?**

Yes, in the event there has been an inurnment in a niche and the personal representative or immediate family of the person whose cremains have been inurned wish to permanently remove the cremains from the niche, they may do so. However, there will not be any reimbursement in this case.

## **May I change the list of people who may be inurned in my niche in the columbarium?**

Yes, during your lifetime, you may change the list of designated persons by a written amendment to the niche purchase agreement signed by the church representative and yourself.

# Frequently Asked Questions

## **What other costs are involved in being inurned at the Faith Presbyterian Church Columbarium?**

Costs not included:

1. Cremation and other funeral home expenses
2. The purchase of an urn
3. Memorial service
4. Honorarium for minister, musicians, etc. are separate and subject to the church's policies and fee schedules.

# QUESTIONS?

- Contact Larry Handeland at [bandgfaith@gmail.com](mailto:bandgfaith@gmail.com) or via cell phone at (843) 685-1126.